



**23 Heywood Gardens, Maidenhead, SL6 3LY**  
**£110,000**

 **HORLER**

## 23 Heywood Gardens, Maidenhead, SL6 3LY

Located in the charming Heywood Gardens of Maidenhead, this delightful two-bedroom single unit park home offers a perfect blend of comfort and convenience.

This park home is an excellent opportunity for those seeking a peaceful lifestyle in a well-connected area. With its inviting interiors and lovely outdoor space, it is sure to appeal to a variety of buyers. Don't miss the chance to make this charming property your new home.

Call today on 01753 621234 to arrange a viewing



## Property Summary

Located in the charming Heywood Gardens of Maidenhead, this delightful two-bedroom single unit park home offers a perfect blend of comfort and convenience. Upon entering, you are welcomed by a spacious living room, ideal for relaxation and entertaining. The fitted kitchen boasts a range of eye and base level units, complemented by integral appliances, making it a joy for any home cook.

The property features a well-appointed family bathroom, ensuring practicality for everyday living. The first bedroom is a generous double, complete with fitted wardrobes that provide ample storage space. The second bedroom also benefits from fitted storage, making it suitable for guests or as a home office.

Outside, the property is enhanced by street parking at the front, providing easy access. The wrap-around garden is a true highlight, offering a secluded and fenced space perfect for enjoying the outdoors. A wooden garden shed at the rear adds extra utility for storage or gardening tools.

This park home is an excellent opportunity for those seeking a peaceful lifestyle in a well-connected area. With its inviting interiors and lovely outdoor space, it is sure to appeal to a variety of buyers. Don't miss the chance to make this charming property your new home.

Call today on 01753 621234 to arrange a viewing

## General Information

Council Tax Band 'A'

Family Park

Pitch Fee £258.26 per month

Pet Friendly

Age of Unit 35 years

Mains Gas

Monthly Outgoings - approx Electricity £37.00/Gas  
£35.00

## Legal Note

\*\*\*Although these particulars are thought to be materially correct, their accuracy cannot be guaranteed and they do not form part of any contract\*\*\*





# Haywood Gardens SL3

Approximate Gross Internal Floor Area = 35.5 sq m / 383 sq ft

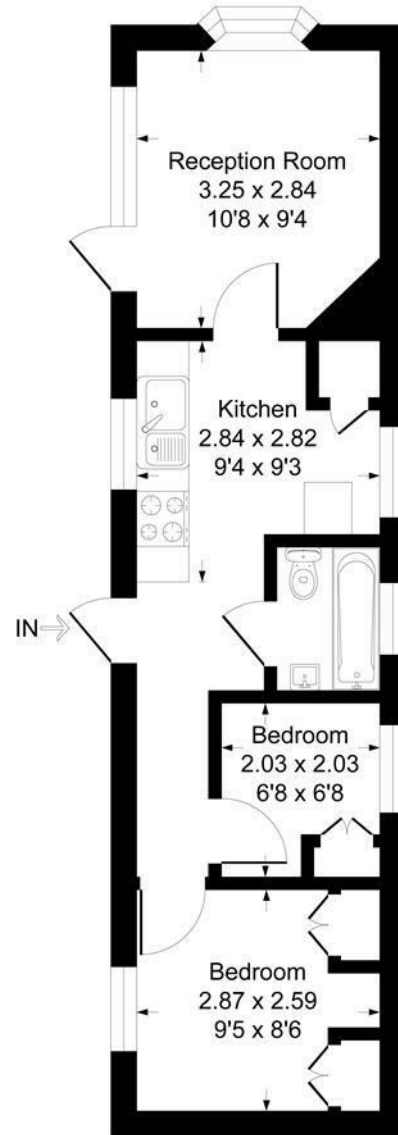

Illustration for identification purposes only, measurements are approximate, not to scale.  
Produced By Esjay Property Marketing